



**FITTING INSTRUCTIONS**

**27P**

Thank you for purchasing a set 27P bushes for your Mazda MX5 MK 3. The following instructions will help you fit these bushes correctly to ensure optimal performance.

The bag for 27P contains 2x 27P castings in our Dynamic grade (orange) and 2x 27P tubes.

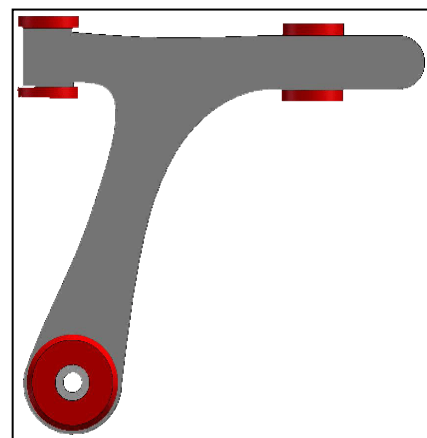
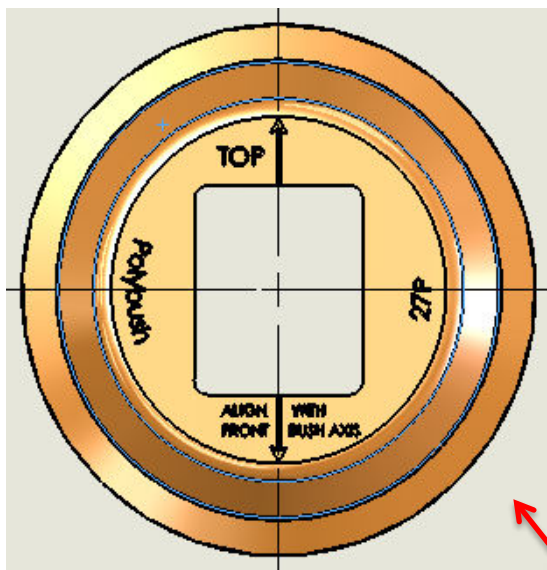

The top of the bush is shown above and is to be fitted into the arm with the writing facing upwards.

The orientation of the bush should show the two arrows pointing towards the front and rear of the vehicle.

If you have any questions regarding the fitment of these bushes, please give us a ring on 01978664316 or send us an e-mail on [sales@polybush.co.uk](mailto:sales@polybush.co.uk).