



FITTING INSTRUCTIONS
Kit 214 - Toyota Yaris GR GXPA16 (2020-On)

7BU - Front Wishbone Bush Front Bush

Step 1: Remove existing OE bush including the outer metal shell. Ensure no sharp edges are left in the bore.

Step 2: Apply washing up liquid to the leading edge of the bush and the inside of the wishbone bore. The front side of the bush is marked.

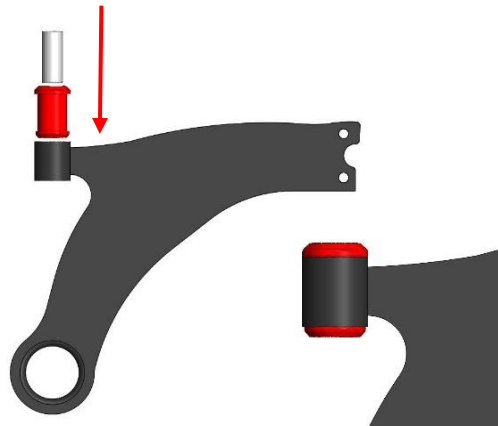
Step 3: Push in bush until fully seated. Insert the inner tube

7BV - Front Wishbone Bush Rear Bush

Step 1: Remove existing OE bush including the outer metal shell. Ensure no sharp edges are left in the bore.

Step 2: Press the Polybush outer metal shell into the bore from the top of the arm (radiused side) until flush with the top side of the arm.

Step 3: Apply washing up liquid or similar to the leading edge flange, bore of the bush and the outer metal.

Step 4: Insert the bush into the housing at a slight angle and push until the flange pops through on the underside.

Step 5: Insert the inner tube until flush.

Step 6: Refit the arm to the bracketry and tighten to OE torque specifications at ride height.
NOTE: Ensure suspension is settled.

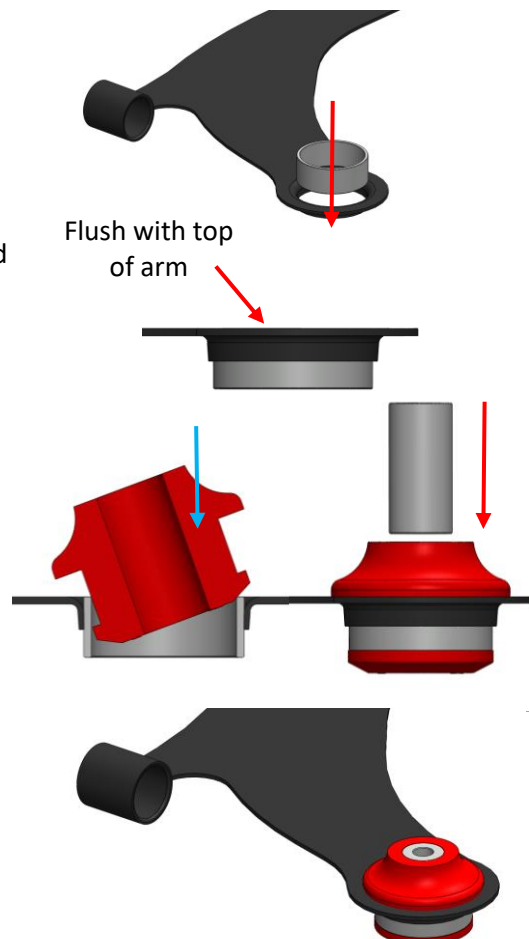



FITTING INSTRUCTIONS

Kit 214 - Toyota Yaris GR GXPA16 (2020-On)

7BY - Rear Lower Rear Control Arm Inner Bush (Spring Bucket)

Step 1: Using the provided removal/installation tool, press out the OE bush. NOTE: Ensure the removal tool is seated before applying large pressure as this may damage the arm.

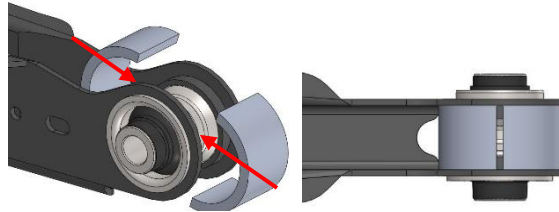

Step 2: With the installation tool still in place, press the 7BY outer shell in until flush with either side. NOTE: The arm has 2 different bore ID's so it can only fit in one direction as per the OE bush.

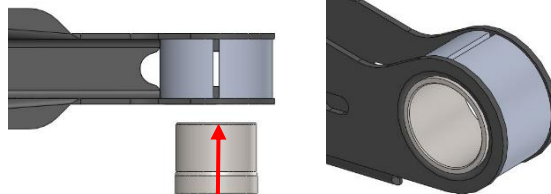

Step 3: Apply washing up liquid to the bushes leading flange and outer metal bore.

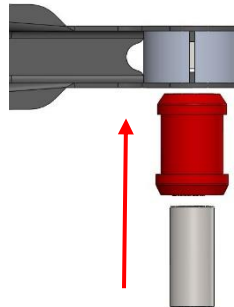

Step 4: Insert the bush in the direction shown below until fully seated. Insert inner tube.

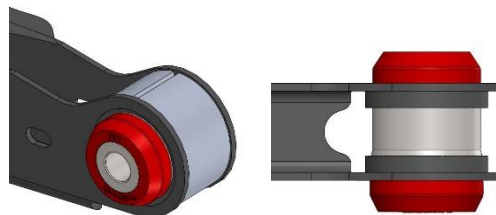

Step 5: Remove the Installation tool

Step 6: Refit the arm to the bracketry and tighten to OE torque specifications at ride height. NOTE: Ensure suspension is settled.

FITTING INSTRUCTIONS
Kit 214 - Toyota Yaris GR GXPA16 (2020-On)
7CA - Rear Trailing Arm Bush

Step 1: Remove existing OE bush including the outer metal shell. Ensure no sharp edges are left in the bore.

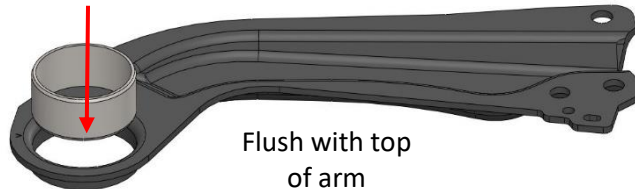

Step 2: Press the Polybush outer metal shell into the bore from the top of the arm (radiused side) until flush with the top side of the arm.

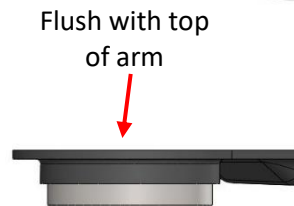

Step 3: Apply washing up liquid or similar to the leading edge flange, bore of the bush and the outer metal.

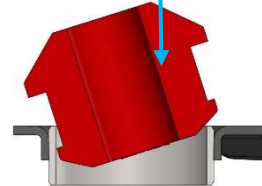

Step 4: Insert the bush into the housing at a slight angle and push until the flange pops through on the underside.

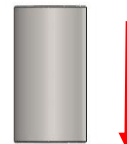

Step 5: Insert the inner tube until flush.



Step 6: Refit the arm to the bracketry and tighten to OE torque specifications at ride height.
NOTE: Ensure suspension is settled.





FITTING INSTRUCTIONS
Kit 214 - Toyota Yaris GR GXPA16 (2020-On)
7CE - Rear Drop Link Bush

Step 1: Remove existing OE bush including the outer metal shell. Ensure no sharp edges are left in the bore.

Step 2: Apply washing up liquid to the bushes leading flange and inner drop link bore.

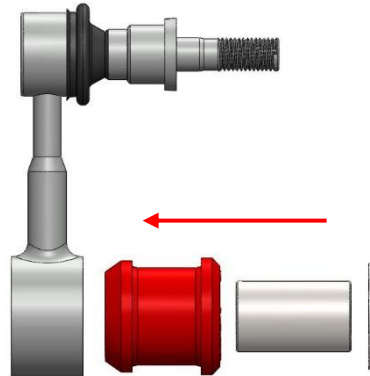
Step 3: Push the bush with the leading flange facing towards the inside of the car until seated. NOTE: Outer side of bush is marked.



Step 4: Insert tube until flush with bush.

Step 5: Place the washer on the outer side of the bush and push the bolt through.

Step 6: Refit drop link to the vehicle and tighten to OE specification when at ride height and the vehicle is settled.

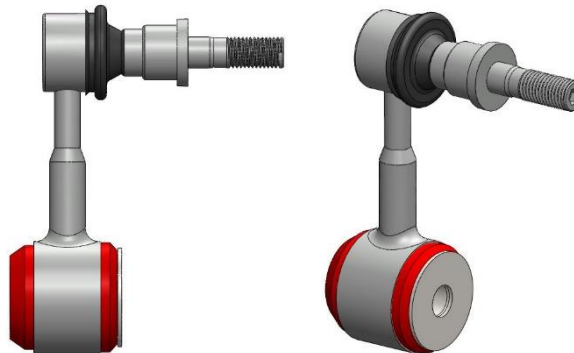
7CB, 7CC & 7CD Front and Rear Anti-Roll Bar Bushes

Step 1: Remove the OE bushes. Note: All OE bushes are glued to the Anti-Roll bars.

Step 2: Wrap the ARB bushes around the bar into the correct location. NOTE: It is recommended to fit a jubilee clip to the bar at either side of the bush to ensure the bar cannot walk from left to right.

Step 3: Fit the ARB bracket around the bush ensure the bush is central.

Step 4: Refit the bar to the vehicle and tighten to OE specification when at ride height and the vehicle is settled.

If you have any questions regarding the fitment of these bushes, please give us a ring on 01978 664316.

or send us an e-mail - sales@polybush.co.uk.