

FITTING INSTRUCTIONS
24V - Rear Shock Absorber Upper Bush
24V Contains:

2 x Polyurethane Pieces
2 x 40DK Inner Tubes
4 x 7CE Washers

Step 1:

Remove the existing bushes. Ensure the outer plastic shell is also removed.

Step 2:

Ensure the bore is clean and free from debris.

Step 3:

Apply a small amount of washing-up liquid or similar to a edge of the bush.

NOTE: This bush is symmetrical so can be fitted either way.

Step 4:

Press the bush into the housing until fully seated.

Step 5:

Insert the inner tube until flush either side of the bush.

Step 6:

When refitting the shock to the vehicle, ensure a washer is fitted either side of the bush.

Step 7:

Torque to manufacturers settings when the vehicle is at ride height.

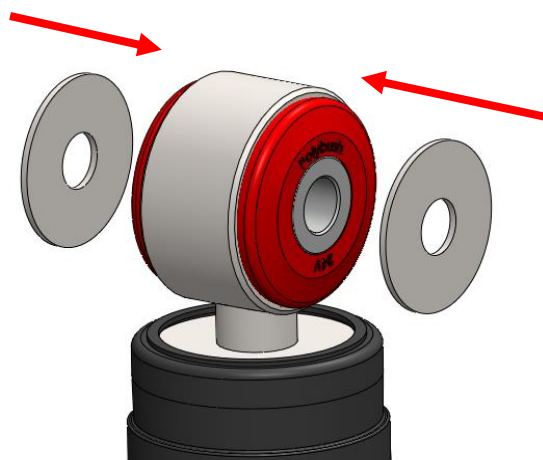
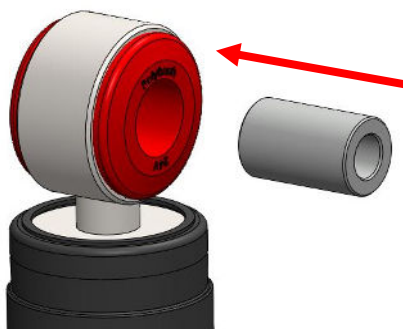
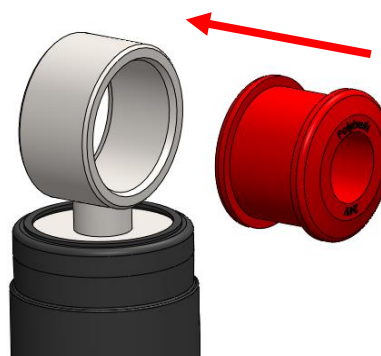

If you have any questions regarding the fitment of these bushes, please give us a ring on 01978 664316 or send an e-mail to sales@polybush.co.uk.